

## ■ About Us

The Former Residence of YOSHIDA Shigeru was a private residence of YOSHIDA Shigeru in. He was the Japanese Prime Minister in 1940-1950s. In 1887, YOSHIDA's foster father bought land in Oiso, and he built a holiday villa there. After his father died, YOSHIDA inherited it along with other property. He spent his later years in this residence.

This building was restored after it was burnt down in 2009. We rebuilt "Osetsu-to"(built around 1947), and "Shin-kan"(new buildings) that were designed by the famous architect YOSHIDA Isoya in the 1930s. YOSHIDA Isoya invented a new architectural style. He made modern Japanese houses that were based on the style of "Sukiya", a Japanese traditional tea ceremony building. The Former Residence of YOSHIDA Shigeru was reconstructed in his style: a mix of Art Deco and Japanese traditional architecture but modern construction materials and so on were used.



## 旧吉田茂邸 (大磯町郷土資料館別館)

Former Residence of YOSHIDA Shigeru

### ■ Hours

9:00 — 16:30 (Last entry 16:00)

### ■ Closures

Closed on Mondays, except on national holidays.

When Monday is a holiday, the museum is open and closed the following Tuesday.

Closed the first of every month.

Closed the year-end and New Year holidays (12/29 - 1/4)

### ■ Admission

Adults: 510 (460) yen

Under high school Students: 210 (160) yen

\* ( ) indicate prices for those in groups of 20 or more.

\* Disabled visitor and one caretaker are admission free.

Please present Disabled Person's Notebook.

\* Students are asked to show their student ID.

### ■ Access

Train, JR Tokaido line, Oiso station (2km/ 30mins walk)

Bus, 二宮駅行, 湘南大磯住宅行 (磯 07, 13, 14, 平 47),

Joyama park-MAE (5mins walk)

### ■ Address

418 Nishikoiso, Oiso-machi, Naka-gun, Kanagawa-ken,

255-0005

### ■ Contact

TEL : +81-463-61-4777

FAX : +81-463-61-4779

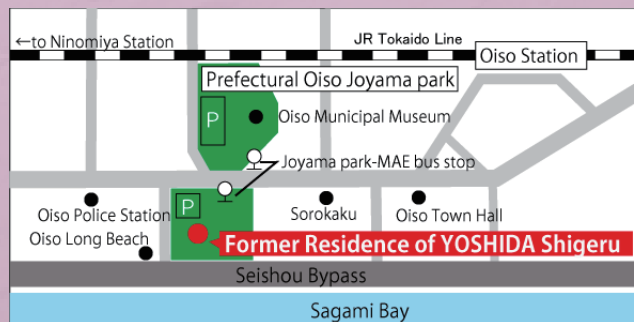

### Website

<http://www.town.oiso.kanagawa.jp/oisomuseum>



*Former Residence*  
*of*  
***YOSHIDA Shigeru***

## FLOOR GUIDE



**Gin no Ma (Silver Room)**

The Silver Room was Shigeru Yoshida's private study and bedroom. He passed away peacefully in his sleep in this room.



**Kin no Ma (Golden Room)**

The Golden Room was a reception room for honored guests. With the screen doors open, we can see the mountains of Hakone, Mount Fuji, and the Pacific Ocean.



**Dining Room (Rose Room)**

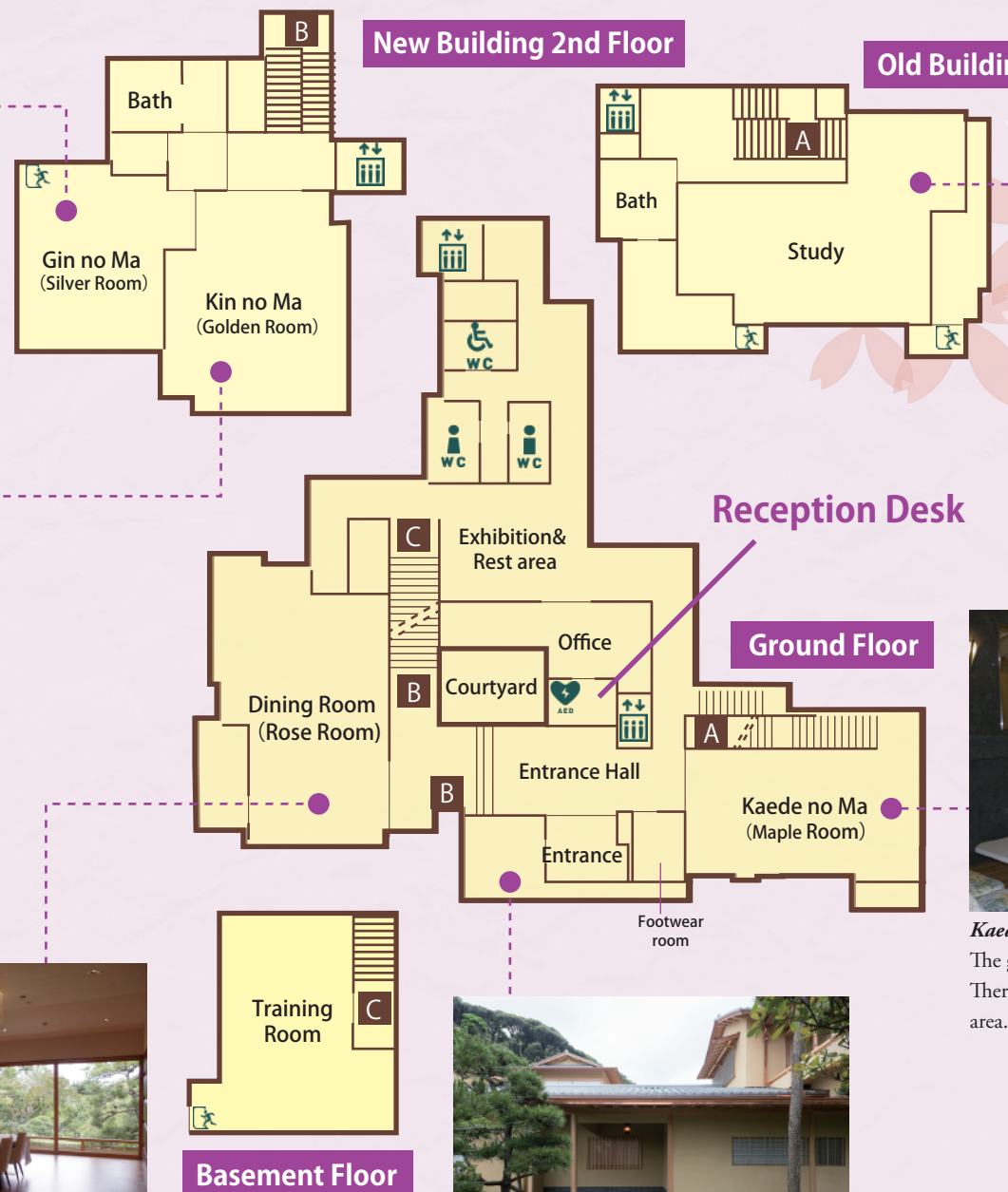

**Entrance**

### Old Building 2nd Floor



**Study**

The upper floor was Shigeru Yoshida's private room. There was a Kotatsu and in the small cabinet was Yoshida's famous black phone. It had no dial. This was a direct line to Government offices in Tokyo.

### Reception Desk

### Ground Floor



**Kaede no Ma (Maple Room)**

The ground floor was used as a study/reception room. There was a desk for meetings and an informal seating area.

### Please Note

- Do not smoke.
- Do not eat/ drink.
- No Pets.
- Photography is possible in the range of personal use.